

Par	service
3A	Inlet nozzle
3B	Outlet nozzle
4A	Inlet nozzle
4B	Outlet nozzle

TOLERANCES
LENGTHS +/- 1.5 mm
CENTERS +/- 0.8 mm

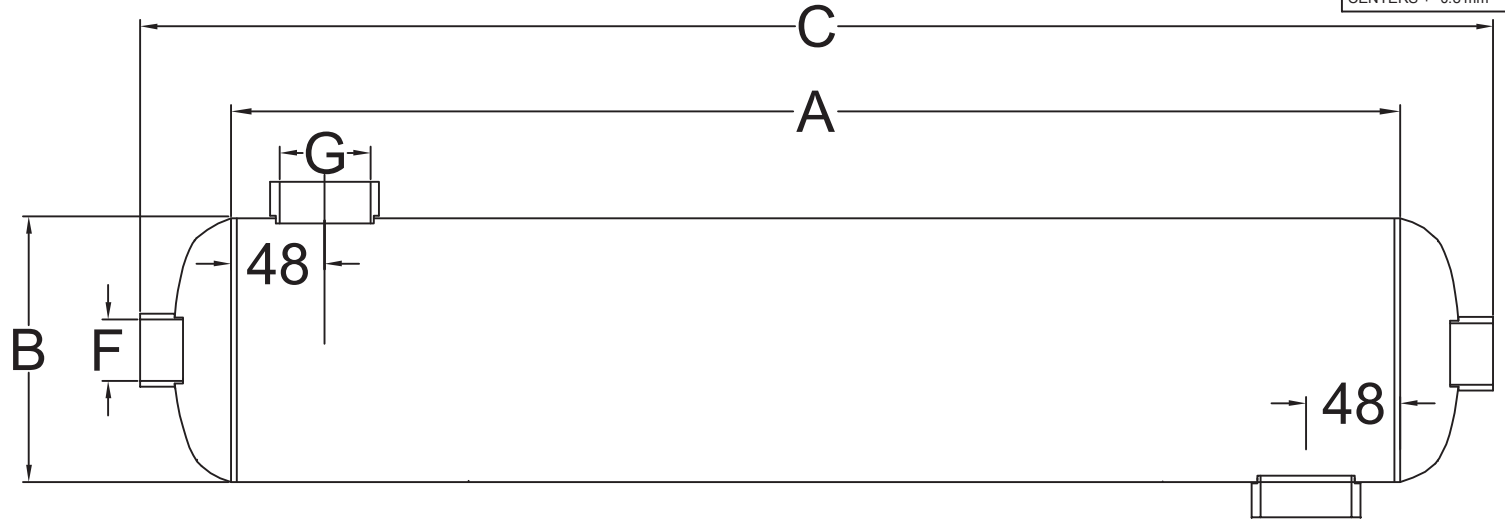
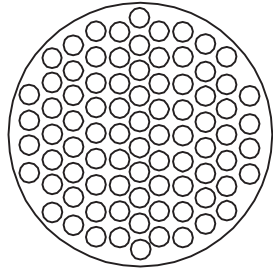

SPECIFICATION OF POOL HEAT EXCHANGERS

Model#	Capacity(kw)	Area(M2)	A	B	C	F(NPT)	G(NPT)	Material
OVT 85	25	0.251	420	60	520	1"	1 1/2"	Full Titanium
OVT 155	45	0.33	350	76	450	1"	1 1/2"	Full Titanium
OVT 210	61	0.443	470	76	570	1 1/2"	1 1/2"	Full Titanium
OVT 300	88	0.641	680	76	780	1 1/2"	2"	Full Titanium
OVT 360	105	0.848	730	89	830	1 1/2"	2"	Full Titanium

HEAT TRANSFER AREA in Above list

NOTE*: EXEMPT BY UHA-51 (d)(1)(a)	SHELL SIDE	TUBE SIDE
Maximum Allowable Working Pressure: psi	190	190
Maximum Allow. Ext. Working Press.: psi	N/A	1645
Minimum Design Metal Temperature: °F	18	18
Maximum Design Temperature: °F	406 F	406 F
Pneumatic Test Pressure: psi	285	285
Medium	Water	Water
STAMPING	NO REQUIRED	NONDESTRUCTIVE EXAM.
PWHT	NO	RT NO
CORR. ALLOWANCE	0.01	PT YES, UW-50
IMPACT TEST	SEE NOTE *	MT NO
VESSEL SERVICE	NO LETHAL	UT NO

EL.	QTY	PART. NO.	MAT.	DRAWING
0				
REV. No.	DATE	REVISION NUMBER & EXPLANATION	SERIAL NUMBER	SHOP ORDER
	MAR. 21. 2009	NONE	00000	000/00
OLSSON POOL PRODUCTS	ASSEMBLY POOL HEX		Lb	NAME: _____ SIGN A DATE: _____
ITEM	CUSTOMER NAME:			
ASME BOILERS & PRESSURE VESSEL CODE SEC. VIII DIV. I ED.2007 ADD.2008	DRAWING No.	N/A	1/1	APPROVED: _____ LANDMARKS: _____ INCHES/MILIMETERS
		SCALE	SHEET	